

ASSEMBLY INSTRUCTIONS

Halle Large Flush Mount

Item # S 4191

WE RECOMMEND INSTALLATION OF THIS LIGHTING FIXTURE BE DONE BY A LICENSED ELECTRICIAN.

WARNING * SWITCH OFF THE MAIN ELECTRICAL SUPPLY FROM THE MAIN FUSE BOX/CIRCUIT BREAKER BEFORE INSTALLATION.**

INSPECT ITEM CAREFULLY BEFORE ATTEMPTING TO INSTALL. IF THERE IS ANY DAMAGE OR OBVIOUS DEFECT, DO NOT INSTALL.

ITEM MAY NOT BE RETURNED ONCE IT HAS BEEN INSTALLED.

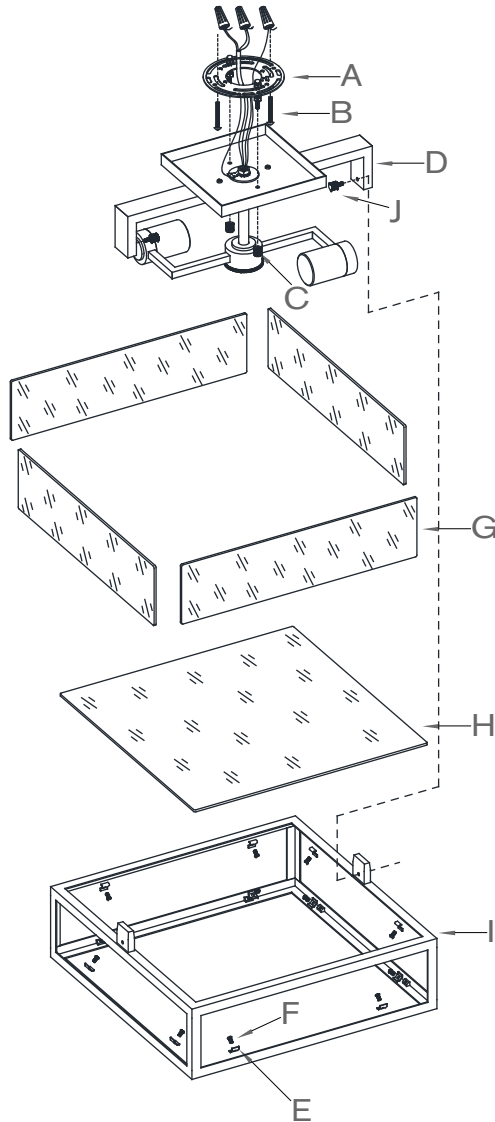

1. Carefully remove all parts from the carton.
2. Remove mounting plate (A) from fixture base (D) by removing cap nuts (C) in counter-clockwise direction.
3. Remove lantern box (I) from fixture base (D) by removing bolts (J).
4. Remove tabs (E) by loosening set screws (F), insert glass panels (G) & (H) to the frame of lantern box (I) and secure by placing tabs (E) to the glass panels (G) & (H) and tighten with set screws (F).
5. Affix mounting plate (A) to ceiling outlet box and secure with mounting screws (B).
6. Gently pull the wires from the wall outlet and allow the wires to hang. Thread the wires through the center hole in mounting plate (A).
7. Attach ground (green) wire to ground wire from wall outlet box (usually green or copper in color), fasten together with a plastic wire connector. Tightly wrap the wire connector with electrical tape, so the end of the connector is sealed. IT IS IMPERATIVE THAT THE OUTLET BOX IN YOUR HOME BE PROPERLY GROUNDED.
8. Connect neutral (white) fixture wire coming from fixture base to neutral (usually white) outlet wire. Fasten both wires together with a plastic wire connector and tightly wrap the wire connector with electrical tape.
9. Repeat the procedure with the hot (black) wires. Always make sure that no wire strands are left outside the connectors. DO NOT REVERSE THE HOT AND NEUTRAL CONNECTIONS OTHERWISE SAFETY WILL BE COMPROMISED.
10. Attach fixture base (D) to the affixed mounting plate (A), letting the rods on mounting plate (A) pass through the hole on fixture base (D) and secure with cap nuts (C).
11. Insert light bulbs into sockets.
12. Replace lantern box (I) to fixture base (D) and secure with bolts (J).
13. Restore power and test fixture. Installation is complete.

*** Clean with a dry, soft cloth only. Use no harsh abrasives or chemical agents.